

LODGE. ROOM.

CIRCULAR DINING TABLE LAYOUT (SEATING FOR 120-160)

12 circle tables for 10 people each

16 circle tables of 10 people each (w/stage removal)

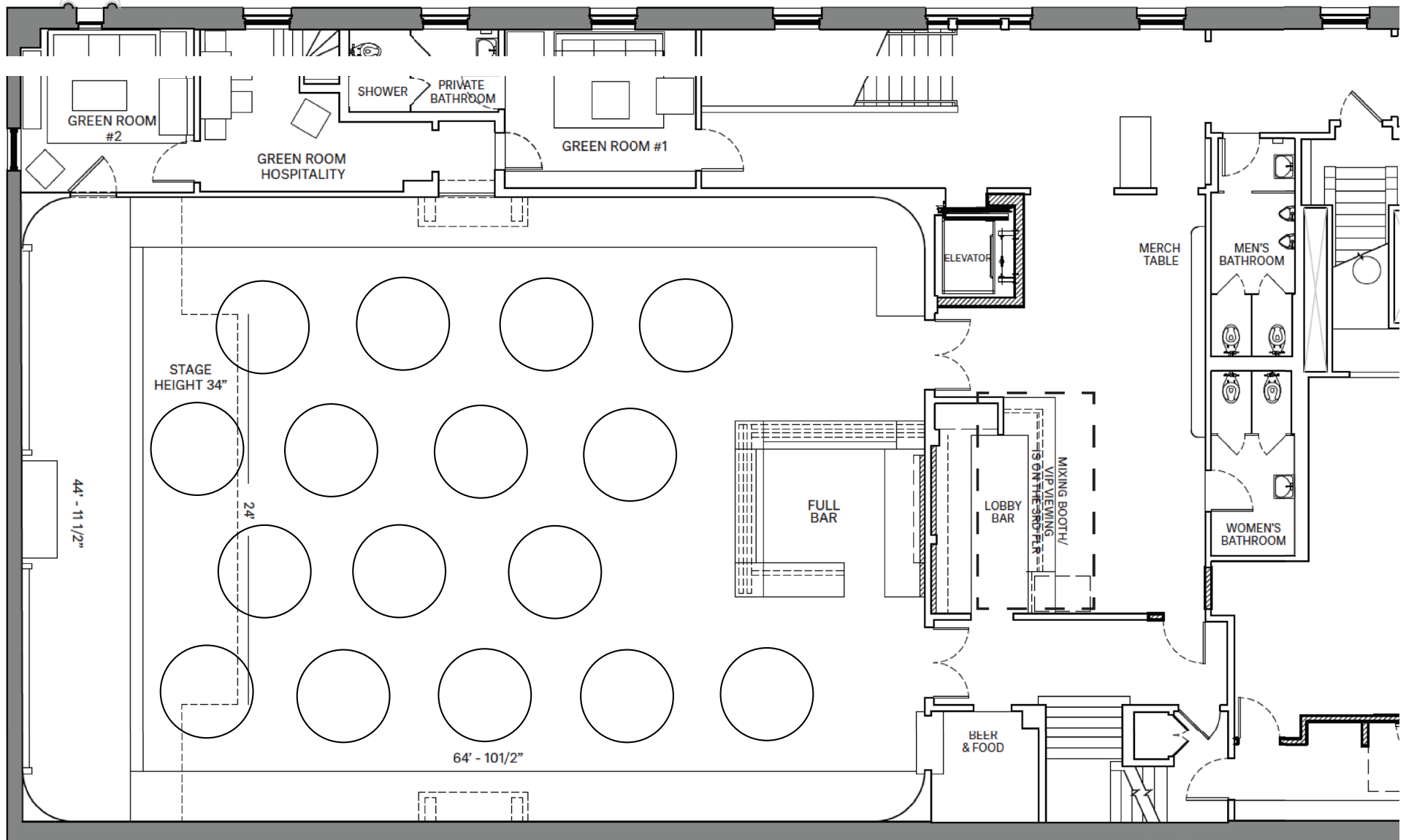

LODGE. ROOM.

RECTANGULAR DINING TABLE LAYOUT (SEATING FOR 140-180)

14 rectangle tables for 10 people each
18 rectangle tables of 10 people each (w/stage removal)

